

5 Chalet Road Kellyville NSW

6 3 3

Few homes possess the glamour and sophistication of this brand new luxury residence, nor an address so desirable for its grand positioning, privacy, and convenience. This spectacular home combines these key elements of upscale living, making it this suburb's most impressive offering. The modern, open-plan layout ensures seamless flow between living spaces, perfect for both family living and entertaining. The unique, high side setting and northern aspect invite boundless natural light year round. Blissfully private and peaceful, this show-stopping home combines flawless style and attention to detail with the promise of low-maintenance comfort in a blue ribbon locale.

Newly built to a cutting-edge designer specification, this home is a true urban paradise. Every detail has been meticulously crafted to provide the ultimate in luxury and style. With its strong crossover appeal, this property is ideal

Price : Contact Agent
Land Size : 759 sqm



Alexandra Meadth
02 8834 3200



Laura Nasr
02 8834 3200



Alexandra Meadth
02 8834 3200



5 Chalet Road
Kellyville, NSW 2155

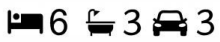

All information contained in this document is from sources we believe to be accurate, however we cannot guarantee its accuracy. Interested persons should make and rely on their own enquiries in relation to measurements, dimensions, layout, furniture and description.



GROUND FLOOR



FIRST FLOOR

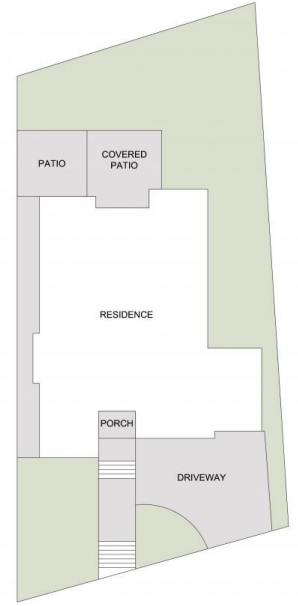

SITE PLAN (NOT TO SCALE)

