

1 Eaglewood Gardens BEAUMONT HILLS NSW

4 4 2

Raise your quality of life to new heights in this luxurious Eden Brae home, striking in its grand proportions and beautifully considered floorplan, making it ideal for growing and mature families alike.

Land Size : 500 sqm

Oozing class, this fully renovated, contemporary residence enjoys a commanding east-facing street presence a standout home in a quiet street, in one of Beaumont Hills most sought after pockets. The immaculately kept gardens are a true delight and offer a taste of what is to come inside.

Come on in:

Grand double entry doors open to a spacious foyer. The main living and family areas of the home are havens for relaxation a separate family room, along with an open plan

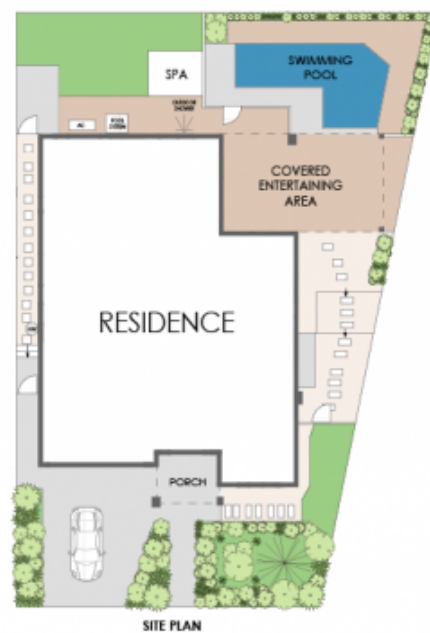

Scale in metres, indicative only. Dimensions are approximate. All information contained herein is gathered from sources we believe to be reliable. However we cannot guarantee its accuracy and interested parties should rely on their own enquiries. Floor plan created by Onebox Media.

1 Eaglewood Gardens, Beaumont Hills

Open RE