



25 Galati Street RIVERSTONE NSW

4 2 2

Simply Delightful!

Land Size : 327 sqm

First Impressions:

A Light and bright family home, tastefully renovated and ideally positioned in the ultra-convenient and ever-popular suburb of Riverstone.

Minutes to Riverstone train station and in catchment for Riverstone Public School, Riverstone High/Wyndham College for senior schooling. A short drive to the Rouse Hill Town Centre as well as an array of parks, caf?s and shopping facilities are at your convenience. A spectacular opportunity for growing or established families to move into their new home!

Come In:

Tidy, spacious and welcoming, the thoughtfully crafted floor



SITE PLAN

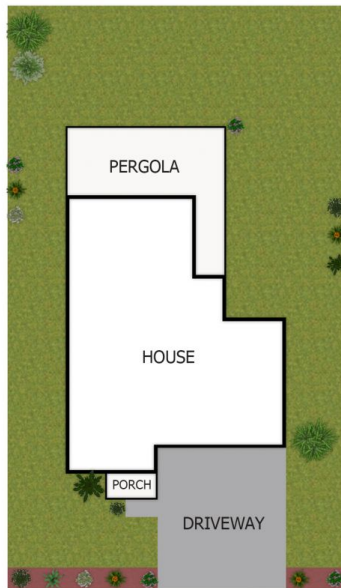

GROUND FLOOR

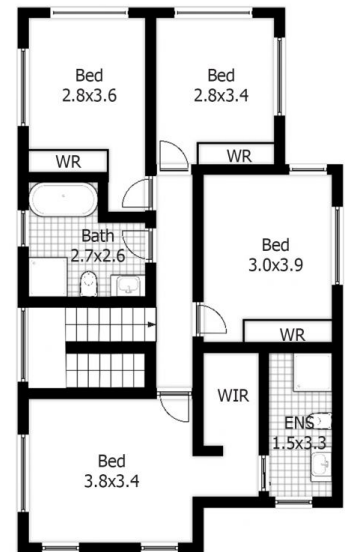

FIRST FLOOR

DISCLAIMER:

This floor plan is used for marketing purpose only and is subject to errors and inaccuracy. The marketing Agent & N2 Media will not accept any liability. Interested parties should make and rely on their own enquiries.